

## Grooved End Y-Strainer

PN25/Class250

Fig. 7901

- Working Pressure and Temperature**

Working pressure PN25/Class250.  
Temperature from -10°C to 120°C.



- Groove Type**

Groove dimensions comply with Metric or AWWA C606 standard.

- Standard Screens**

Size	Hole Dia.	Free Flow Area
DN50 to 80	1.5mm	33%
DN100 to 300	3.0mm	40%

- Materials Specification**

Part Name	Material	EN Spec.	ASTM Spec.
Body	Ductile Iron	EN-JS1050	A536 65-45-12
Cover	Ductile Iron	EN-JS1050	A536 65-45-12
Screen	Stainless Steel	BS970 304S15	AISI 304
Gasket	Teflon / Graphite	Commercial	Commercial
Plug	Ductile Iron	EN-JS1050	A536 65-45-12

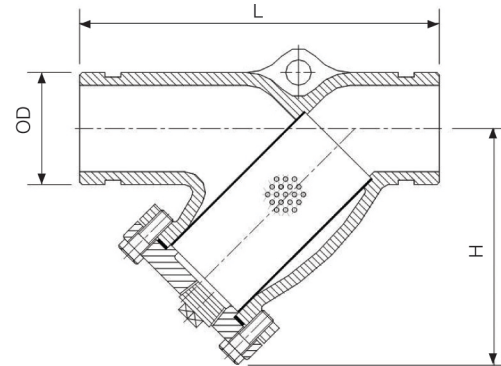

- Dimensions (mm)**

Size	50	65	80	100	125	150	200	250	300
OD	60.3	73.0/76.1	88.9	114.3	139.7/141.3	165.1/168.3	219.1	273.0	323.9
L	225	285	318	375	448	502	640	710	780
H	152	215	219	254	322	365	462	540	610
Plug	1/2"	1"	1"	1-1/2"	2"	2"	2"	2"	2"