

Thread End Y-Strainer | PN25/Class250

Fig. 7701

- Working Pressure and Temperature**

Working pressure PN25/Class250.
Temperature from -10°C to 120°C.



- Thread Type**

NPT thread or Metric thread.

- Materials Specification**

Part Name	Material	EN Spec.	ASTM Spec.
Body	Cast Iron	EN-JL1040	A126 class B
Cover	Cast Iron	EN-JL1040	A126 class B
Screen	Stainless Steel	BS970 304S15	AISI 304
Gasket	Teflon / EPDM	Commercial	Commercial
Plug	Cast Iron	EN-JL1040	A126 class B

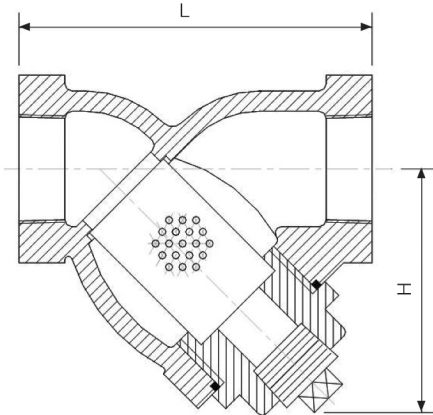

- Dimensions(mm)**

Size	15	20	25	32	40	50	65	80
L	85	98	116	135	154	190.5	223	254
H	62	72	87	100	115	145	184	189
Screen Hole Dia.	1.0	1.0	1.0	1.0	1.0	1.0	1.0	1.0
Plug	3/8"	1/2"	1/2"	3/4"	3/4"	1"	1"	1-1/4"