

Double Sphere Union Type Rubber Expansion Joint

PN16

Fig. 8701

- Working Pressure and Temperature**

Working pressure PN16.
 Explosive Pressure 48 bar.
 Vacuum Rating 400mmHg.
 Temperature from -10°C to 120°C for EPDM.
 Temperature from -10°C to 82°C for NBR.
 Temperature from -10°C to 110°C for Neoprene.



- Medium:** Air, Water, Oil, Acid, Alkali etc.
- End Thread Type:** NPT or BSP thread.
- Materials Specification**

Part Name	Material
Rubber	EPDM/NBR/Neoprene
Carcass	Nylon Cord Fabric
Reinforcing Wire	Spring Steel Wire
Union	Malleable, Zinc Plated

- Dimensions (mm)**

Size	L	Axial Compression	Axial Elongation	Lateral Movement	Angular Movement $\alpha_1 + \alpha_2$
20(3/4")	200	22	5~6	22	45°
25(1")	200	22	5~6	22	45°
32(1-1/4")	200	22	5~6	22	45°
40(1-1/2")	200	22	5~6	22	45°
50(2")	200	22	5~6	22	45°
65(2-1/2")	240	22	5~6	22	45°

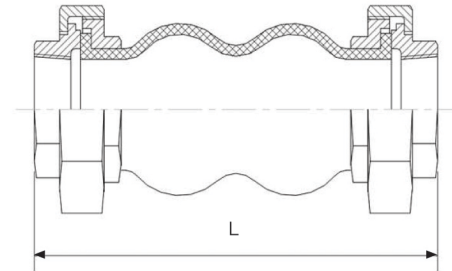

Permits More Movements

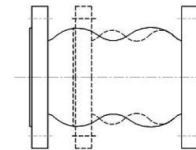

Axial Elongation

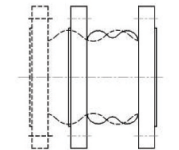

Axial Compression

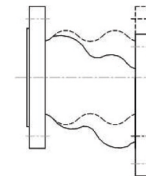

Lateral Movement

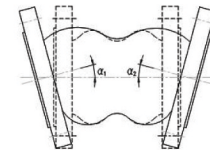

Angular Movement